

Republic

Import Building

Office Space Plans

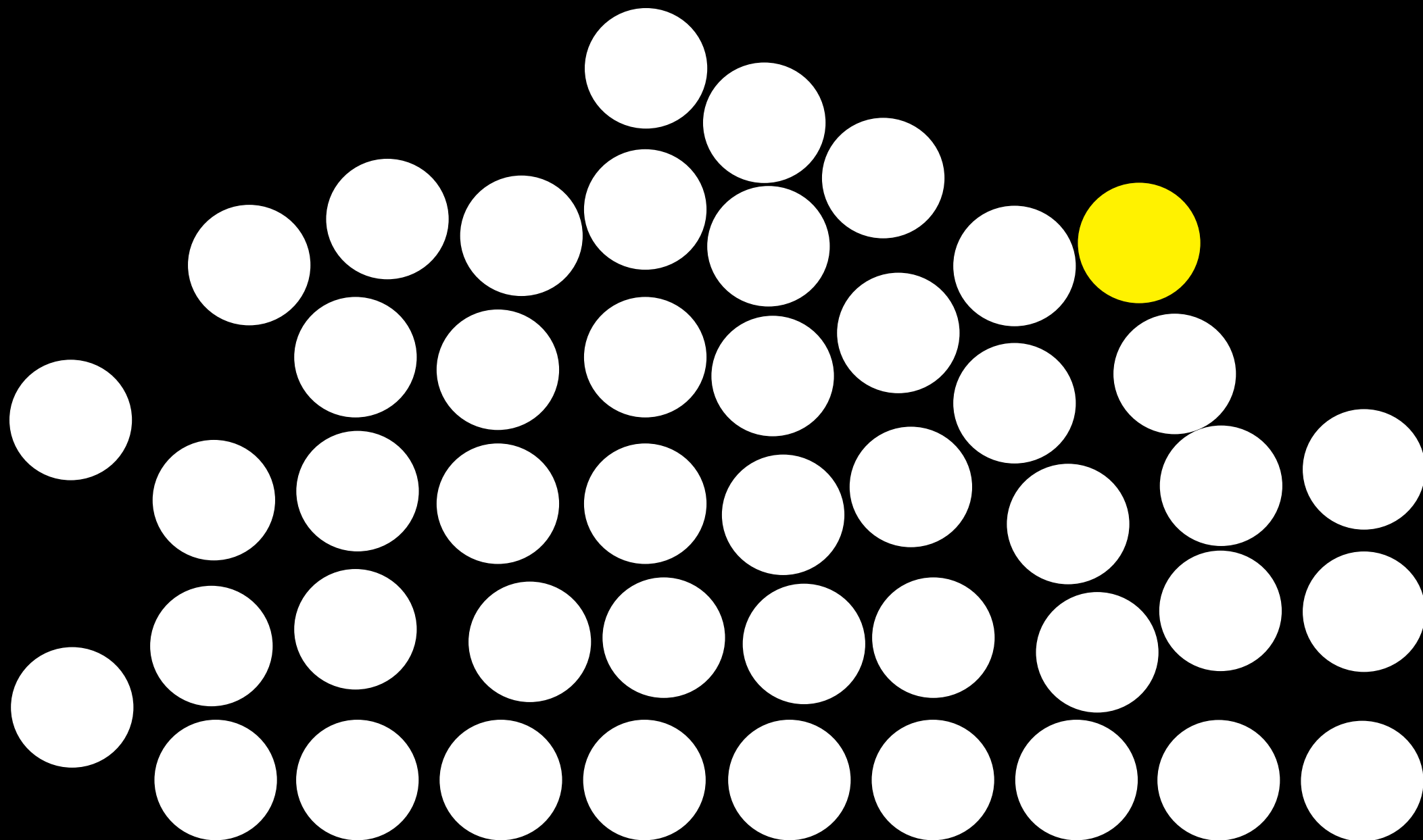

3rd-6th – Space Plan 1

Office: Circa 32,672 sq ft / 3,044 sq m

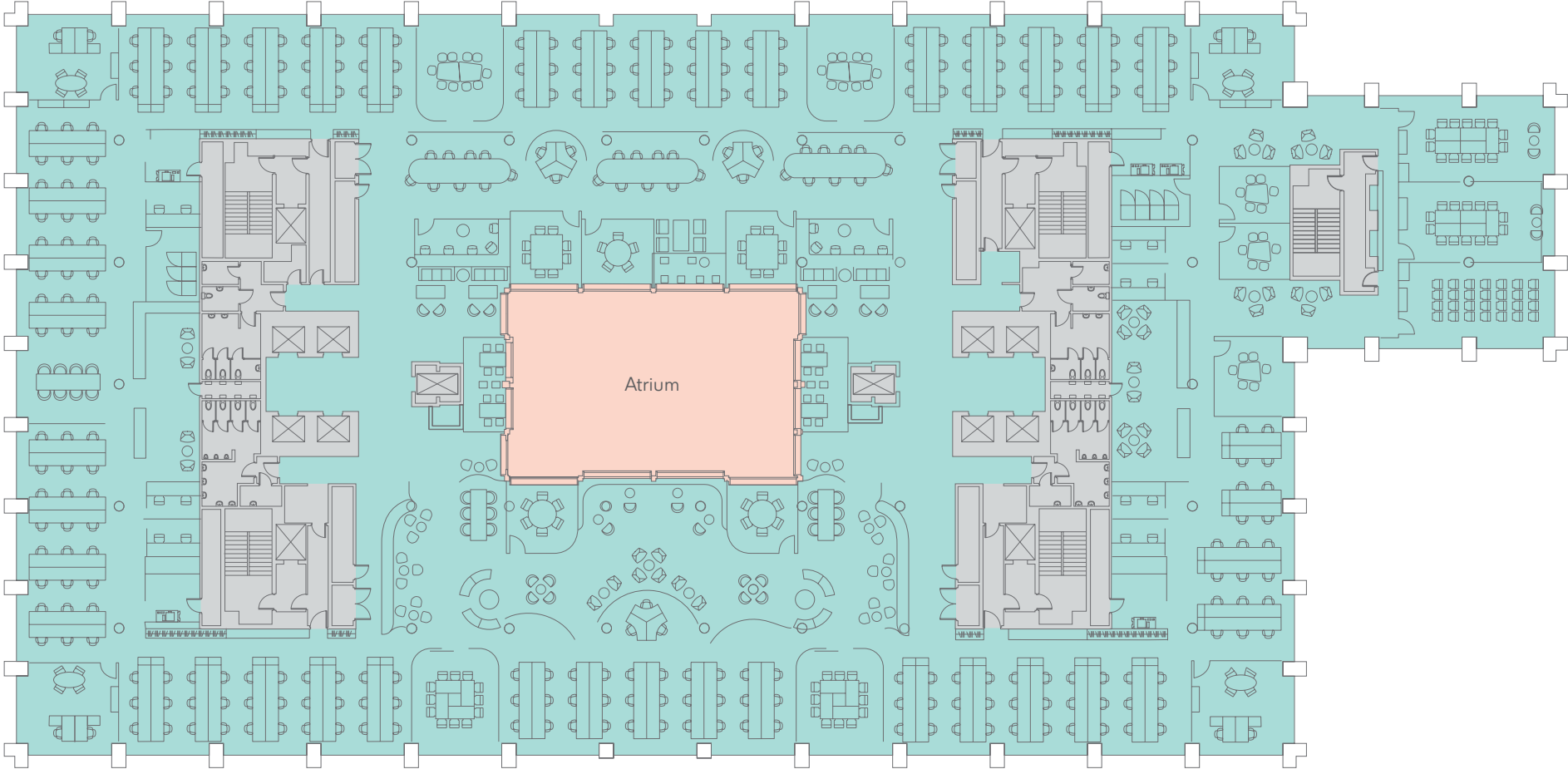

No of people: 292

Occupational density: 1:10 sq m



3rd-6th – Space Plan 2

Office: Circa 32,672 sq ft / 3,044 sq m

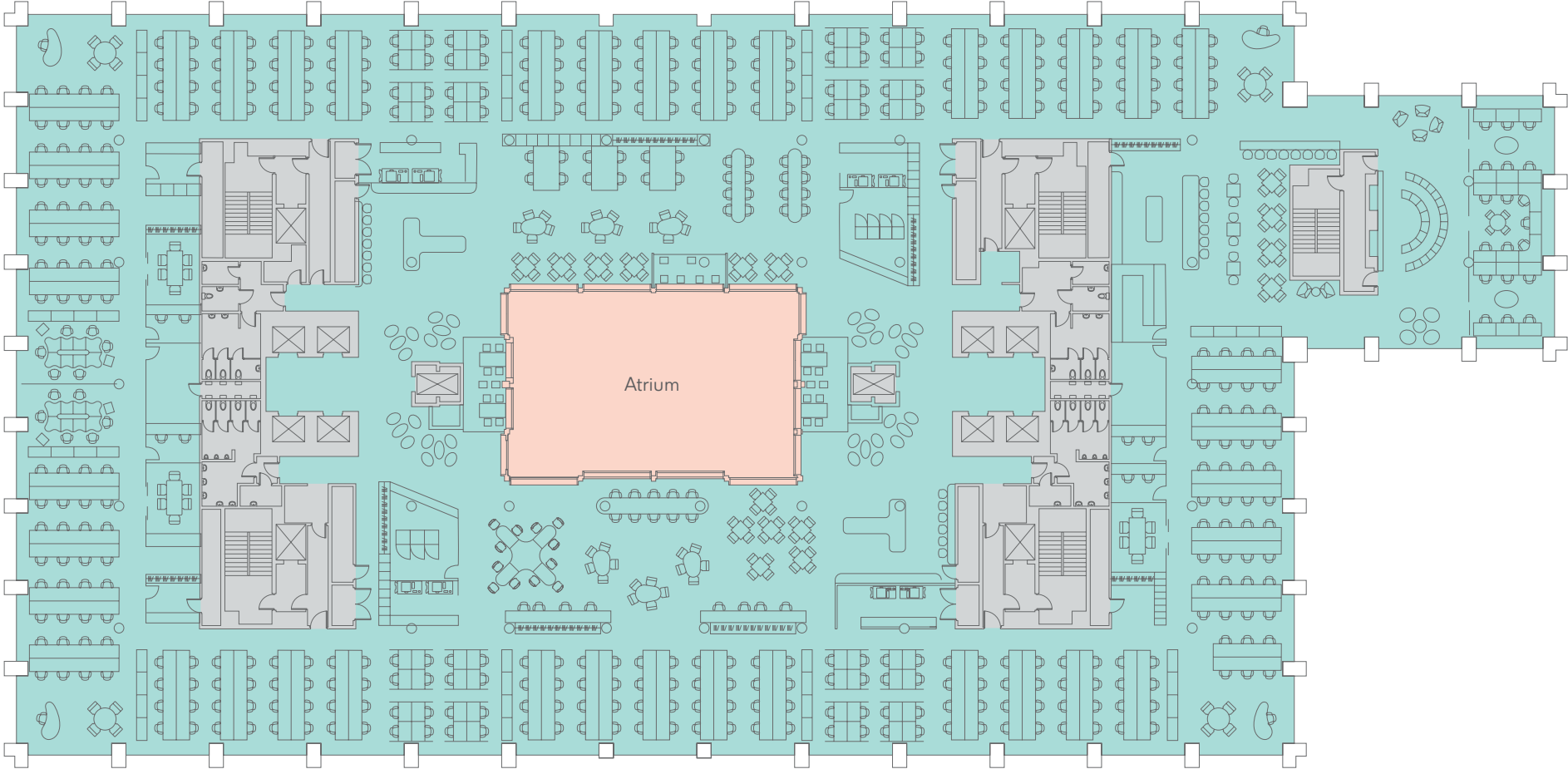

No of people: 490

Occupational density: 1:6 sq m

Contact Details

Office

CBRE

Dan Hanmer
DL +44 (0) 20 7182 3646
M +44 (0) 7985 876 209
dan.hanmer@cbre.com

Luke Hacking

DL +44 (0) 20 7182 2169
M +44 (0) 7951 224 060
luke.hacking@cbre.com

Simon Conie

DL +44 (0) 20 7182 3403
M +44 (0) 7702 974 333
simon.conie@cbre.com

Hannah Grint

DL +44 (0) 20 3257 6341
M +44 (0) 7545 868 543
hannah.grint@cbre.com

Allsop LLP

James Neville
DL +44 (0) 20 7588 4433
M +44 (0) 7789 658 540
james.neville@allsop.co.uk

Rachel Lockhart

DL +44 (0) 20 7588 4433
M +44 (0) 7786 656 661
rachel.lockhart@allsop.co.uk

Tom Nicoll

DL +44 (0) 20 7588 4433
M +44 (0) 7734 680 412
tom.nicoll@allsop.co.uk

Retail

CBRE

Will Brown
DL +44 (0) 20 7182 2785
M +44 (0) 7870 637 267
will.brown@cbre.com

Eloise Ladkin

DL +44 (0) 20 3257 6107
M +44 (0) 7469 375 720
eloise.ladkin@cbre.com

CF Commercial

Craig Fisher
DL +44 (0) 20 3216 3911
M +44 (0) 7947 534 589
craig@cfcommercial.co.uk

Max Taylor-Smith

DL +44 (0) 20 3216 3912
M +44 (0) 7765 251 016
max@cfcommercial.co.uk

Fund Manager

LaSalle Investment Management

Developer

Trilogy

Architects

Studio RHE

Important Notice: 1. Particulars: The particulars are not an offer or contract, nor part of one. You should not rely on statements by Allsop or CBRE in the particulars or by word of mouth or in writing ("information") as being factually accurate about the property, its condition or its value. Neither CBRE or Allsop has any authority to make any representations about the property and accordingly any information give in entirety without responsibility on the part of the agents, seller (s) or lessor (s). 2. Photos etc: The photographs show only certain parts of the property as they appeared at the time they were taken. Areas, measurements and distances given are approximate only. 3. Regulations etc: Any references to alterations to, or use of, any part of the property does not mean that any necessary planning, building regulations or other consent has been obtained. A buyer or lessee must find out by inspection or in other ways that these matters have been properly dealt with and that all information is correct. CGIs are for indicative purposes only and may be subject to change. Allsop is the trading name of Allsop LLP, a limited liability partnership registered in England and Wales with registered company number OC315531. CBRE is the trading name of CBRE Limited, a limited liability partnership registered in England and Wales with registered company number 3536032. October 2018.