

Republic

Import Building

Retail Floor Plan

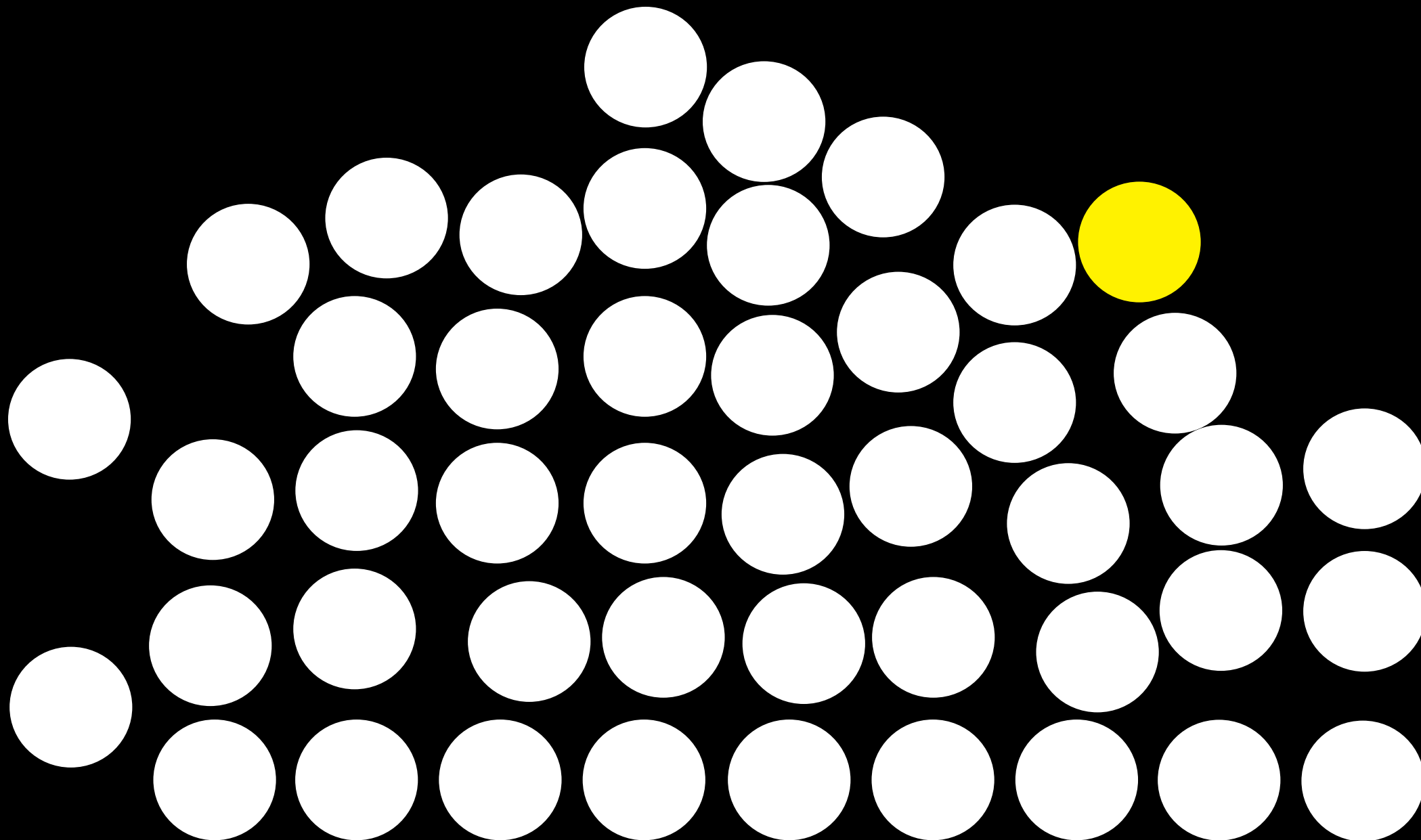

G.03 – A1/A3/A4

Retail: 2,983 sq ft / 277 sq m

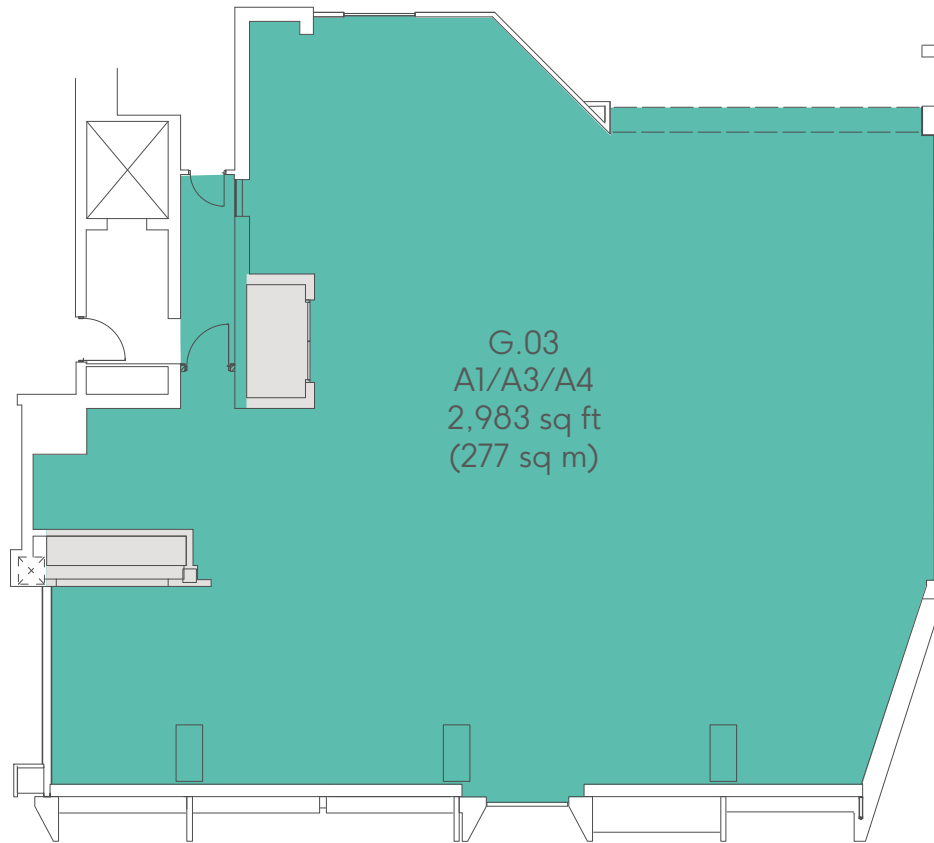

G.05A – A1/A3/A4

Retail: 2,246 sq ft / 209 sq m

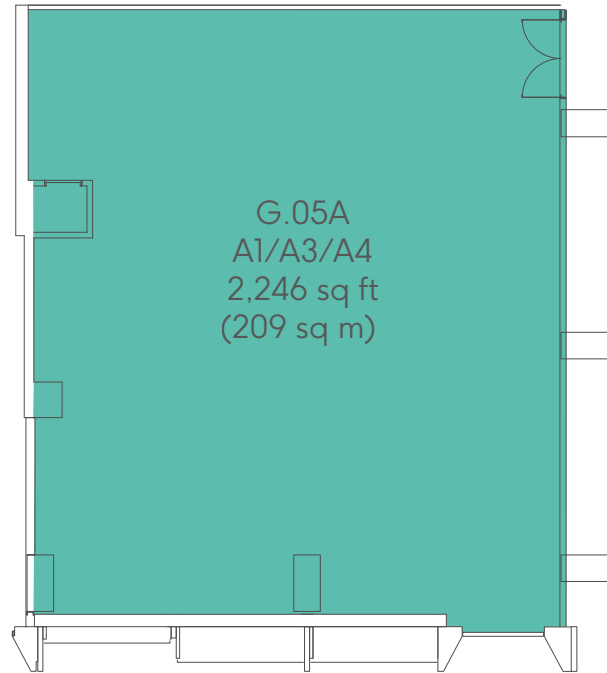



Contact Details

Retail

CBRE

Charlie Reid
DL +44 (0) 20 7182 2473
M +44 (0) 7896 072 899
charlie.reid@cbre.com

—
Eloise Ladkin
DL +44 (0) 20 3257 6107
M +44 (0) 7469 375 720
eloise.ladkin@cbre.com

—
Will Brown
DL +44 (0) 20 7182 2785
M +44 (0) 7870 637 267
will.brown@cbre.com

CF Commercial

Ben Reeve
DL +44 (0) 20 3216 3914
M +44 (0) 7808 904 683
bcreeve@btinternet.com

Fund Manager

LaSalle Investment Management

Developer

Trilogy

Architects

Studio RHE

Important Notice: 1. Particulars: The particulars are not an offer or contract, nor part of one. You should not rely on statements by Allsop or CBRE in the particulars or by word of mouth or in writing ("information") as being factually accurate about the property, its condition or its value. Neither CBRE or Allsop has any authority to make any representations about the property and accordingly any information give in entirety without responsibility on the part of the agents, seller (s) or lessor (s). 2. Photos etc: The photographs show only certain parts of the property as they appeared at the time they were taken. Areas, measurements and distances given are approximate only. 3. Regulations etc: Any references to alterations to, or use of, any part of the property does not mean that any necessary planning, building regulations or other consent has been obtained. A buyer or lessee must find out by inspection or in other ways that these matters have been properly dealt with and that all information is correct. CGIs are for indicative purposes only and may be subject to change. Allsop is the trading name of Allsop LLP, a limited liability partnership registered in England and Wales with registered company number OC315531. CBRE is the trading name of CBRE Limited, a limited liability partnership registered in England and Wales with registered company number 3536032. MArch 2020.